

York County Shore

Lancaster County Shore

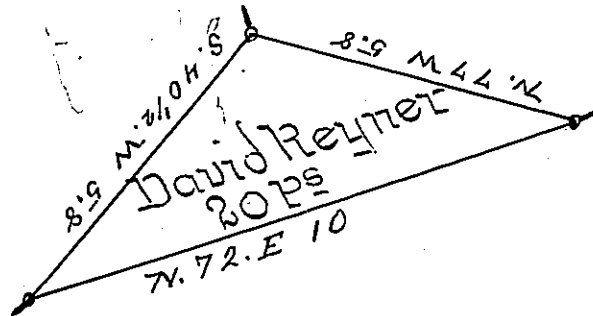

A Draught of an Island Situate in the river Susquehanna Conestogoe Township Lancaster County Called St Joseph about 100 yards East of Persimone Island and about one hundred yards West of the Calgretts Rock Containing twenty perches Strict Measure Surveyed in pursuance of a Warrant dated the 2nd day of February A.D. 1819 granted to David Reyner

By Jacob Hilshman D.S.

To Jacob Spangler Esq: }
Surveyor General

IN TESTIMONY that the above is a copy of the original remaining on file in the Department of Internal Affairs of Pennsylvania, made conformably to an Act of Assembly approved the 16th day of February, 1833, I have hereunto set my Hand and caused the Seal of said Department to be affixed at Harrisburg, this sixth day of June 1899.

James W. Latta
Secretary of Internal Affairs.